

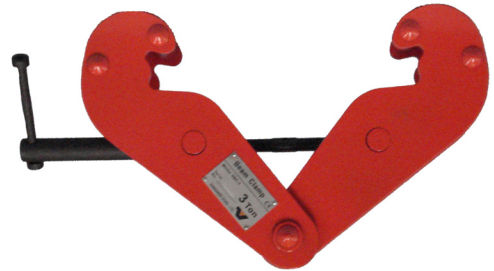

BEAM CLAMPS

VGD Beam Clamps

Model No.	Capacity (tons)	Test Load (kN)	Weight (lbs)	Vanguard Code
VBC1	1	14.71	9.9	3856 0001
VBC2	2	29.42	11.0	3856 0002
VBC3	3	44.13	23.0	3856 0003
VBC5	5	61.92	24.0	3856 0005
VBC10	10	125.00	35.0	3856 0010



Model		VBC 1	VBC 2	VBC 3	VBC 5	VBC 10
Flange Width (mm)		75-220	75-220	80-320	80-320	80-350
Dimensions (mm)	A (maximum)	260	260	354	354	400
	B (minimum)	180	180	235	235	250
	B (maximum)	360	360	490	490	520
	C	64	74	103	110	120
	D	5	6	8	10	12
	E	215	215	260	260	280
	F (maximum)	155	155	225	225	230
	F (minimum)	102	102	140	140	160
G (minimum)	25	25	45	45	70	
H	22	22	24	28	44	

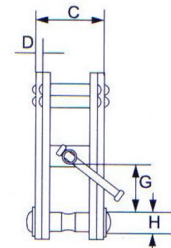
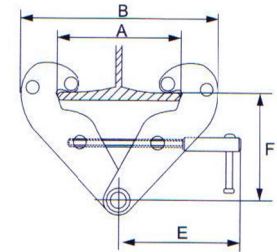

Installation:

THE INSTALLATION of beam clamps must be performed by qualified riggers
 To attach clamps to a beam, open the jaws, slide the clamp over the flange and tighten the locking bar

Warning:

FAILURE TO OBSERVE these warnings may result in serious injury or death!

- These Beam Clamps are designed as an Anchor Point for straight vertical lifts only and **MUST NOT BE USED** in case of side pulls or where the angle of a vertical lift exceeds 3 degrees
- **NEVER EXCEED WORKING LOAD LIMITS**
- **NEVER LIFT LOADS OVER PEOPLE**
- **DO NOT USE these beam clamps:**
 - unless the beams have been tested and approved for attaching lifting devices
 - unless the size range of the clamp corresponds with the size of the beam flange
 - without making sure that they are fully tightened and properly engaged to support the load
 - without making sure that the beams' load rating exceeds the load rating of the beam clamp
 - without closely inspecting for signs of wear or damage prior to use
 - if the load swings during the lifting operation